

Doc#: P 2006 36
Bk&Pg: PL 21 51-52
Filed: 06-26-2006
03:31:48 PM
SLJ
PL

FINAL PLAT

ARBOR LAKE ADDITION, SECTION 5

A PART OF THE N.E. 1/4 SECTION 28, T9N, R3W, LM.
NORMAN, CLEVELAND COUNTY, OKLAHOMA

LEGAL DESCRIPTION

Being a Part of the NE 1/4, SECTION 28, T9N, R3W, of the INDIAN MERIDIAN, NORMAN, CLEVELAND COUNTY, OKLAHOMA, More Particularly described as follows

BEGINNING at the Northeast (NE) corner of said NE 1/4, THENCE South 00°13'17" East along the east section line, a distance of 349.81 feet, THENCE South 89°46'43" West along the North property line of Arbor Lake Addition, formerly known as Waterford Addition (as filed in Book 17, Page 112) a distance of 330.00 feet, THENCE South 00°13'17" East along said property line a distance of 1,34.05 feet, THENCE South 89°46'43" West along said property line a distance of 60.00 feet, THENCE South 00°13'17" East along said property line a distance of 321.58 feet, THENCE South 89°46'43" West along said property line a distance of 192.78 feet to a point on a non-tangent curve and a point on the West right-of-way line of Insha Lane, THENCE along said West right-of-way line along a curve to the left having a radius of 1,175.27 feet (said curve subtended by a chord which bears South 04°39'31" East a distance of 37.68 feet) with an arc length of 37.68 feet, THENCE South 03°34'38" East along said West right-of-way line a distance of 214.27 feet to a point of curvature, THENCE along said West right-of-way line along a curve to the right having a radius of 1,115.27 feet (said curve subtended by a chord which bears South 02°51'57" East a distance of 104.21 feet) with an arc length of 104.25 feet to a point of compound curvature, THENCE along said West right-of-way line along a curve to the right having a radius of 140.31 feet (said curve subtended by a chord which bears South 02°38'40" West a distance of 43.00 feet) with an arc length of 43.32 feet to a point of reverse curvature, THENCE along said West right-of-way line along a curve to the left having a radius of 200.31 feet (said curve subtended by a chord which bears South 09°38'40" West a distance of 66.66 feet) with an arc length of 68.98 feet, THENCE South 44°46'43" West along said West right-of-way line a distance of 35.36 feet, THENCE South 00°13'17" East along said West right-of-way line a distance of 50.00 feet, THENCE South 45°13'17" East along said West right-of-way line a distance of 35.36 feet to a point on a non-tangent curve, THENCE along said West right-of-way line along a curve to the left having a radius of 355.00 feet (said curve subtended by a chord which bears South 07°20'47" East a distance of 88.06 feet) with an arc length of 88.29 feet to a point of reverse curvature, THENCE along said West right-of-way line along a curve to the right having a radius of 295.00 feet (said curve subtended by a chord which bears South 09°16'26" East a distance of 53.52 feet) with an arc length of 53.52 feet to a point on the North property line of Arbor Lake Addition Section 4 (as filed in Book 20, Page 27), THENCE South 89°46'43" West along said North property line a distance of 149.33 feet, THENCE North 00°13'17" West along said North property line a distance of 7.67 feet, THENCE South 89°46'43" West along said North property line a distance of 568.16 feet, THENCE North 00°00'00" East a distance of 212.57 feet, THENCE North 60°00'00" East a distance of 60.00 feet, THENCE North 00°00'00" East a distance of 440.00 feet, THENCE North 30°00'00" West a distance of 600.00 feet, THENCE North 00°00'00" East a distance of 307.90 feet to a point on the North section line, THENCE North 89°46'43" West along said North section line a distance of 1,515.37 feet to the POINT OF BEGINNING. Said tract contains 33.33 acres less and except 0.83 acres of existing right-of-way totaling 32.50 acres more or less.

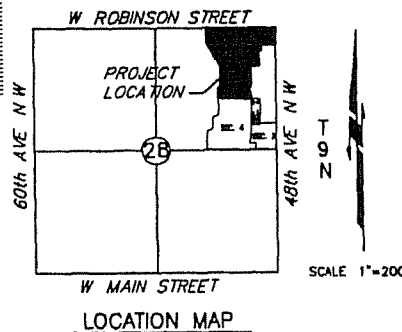

From: Waterwalk LLC
To: The Public

